



## SLIM JIM ALUMINUM GATE

## ASSEMBLY INSTRUCTIONS

AG14002

**60 MIN**  
*Approximate assembly time*

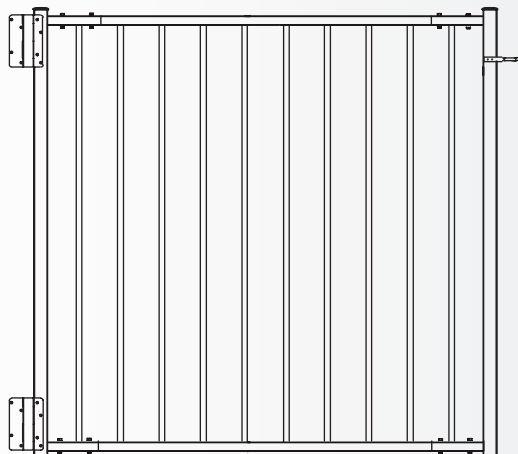

## GENERAL INFORMATION



### IMPORTANT

- + Check the inside of the larger pieces in your box for other materials packed inside.
- + When assembling components, place on a non-abrasive surface (i.e. shipping box) to avoid scratching.
- + We recommend an area approximately 5'x 8' for unobstructed assembling.
- + You should not need to use excessive force when assembling components.

## MISSING OR DAMAGED PARTS?

### VISIT OUR WEBSITE FIRST, SO WE CAN HELP YOU RIGHT AWAY!

Although great care has been taken to ensure proper packaging and handling of this product, occasionally problems occur. If you discover any missing, damaged, or defective parts, please visit our website to order replacement parts. If you experience any further trouble with your product, please contact our customer care department.

 [parts.nychbrands.com](https://parts.nychbrands.com)

 [hmmm@wambamfence.com](mailto:hmmm@wambamfence.com)

 **704-892-5222 / 877-778-5733**

*Customer service agents are available to take calls weekdays from 9am-5pm EST. If you call outside of business hours, please leave a voicemail.*

To help you quickly and accurately, please have reference item number **AG14002** and the specific part name which can be found on page 5. It is helpful if you can provide the batch lot which is a stamped number inside the box.

## NEED ASSEMBLY HELP?

If you are having problems with the assembly or installation of this product, we are happy to assist you with the process. **Please give us a call at 704-892-5222 / 877-778-5733.**

## NEED TO RETURN?

If for some reason you need to return this product, please allow us to help resolve your issues first. If you still decide to return the product, **you will need to initiate the return from the company you originally purchased from.**

## GENERAL INFORMATION

### 1. Read over fence instructions first.

Your gate and fence will work better together if you first take the time to read and understand your fence.

### 2. Pre-assemble the gate frame.

Please do not screw the gate frame together until you have temporarily assembled the gate frame. In other words, do a dry run first. This will ensure:

1. *That you have everything necessary to complete the gate.*
2. *That you will have assembled the gate frame in the correct order.*
3. *All of the pieces fit and function properly.*
4. *The gate height and width are similar to the measurements shown on page four.*

It's easier to troubleshoot when things are not screwed together. After you assemble your gate correctly, please disassemble as necessary, and use the included self-drilling stainless steel screws to permanently assemble the gate.

### 3. Install your gate posts before your fence posts.

Your fence panels will be more forgiving for a custom fit than your gate. Position and install your gate posts before you do anything else.

### 4. Do not hang your gate system off a single non-supported post.

Your gate will perform better and last longer if your hinge post is connected to a panel of fence that is connected to another post. This way, the weight strain will be transferred onto two posts versus just one. Installing fence panels on both sides of your gate is ideal in all situations. If this is not possible because of space restrictions, please contact us for alternative solutions.

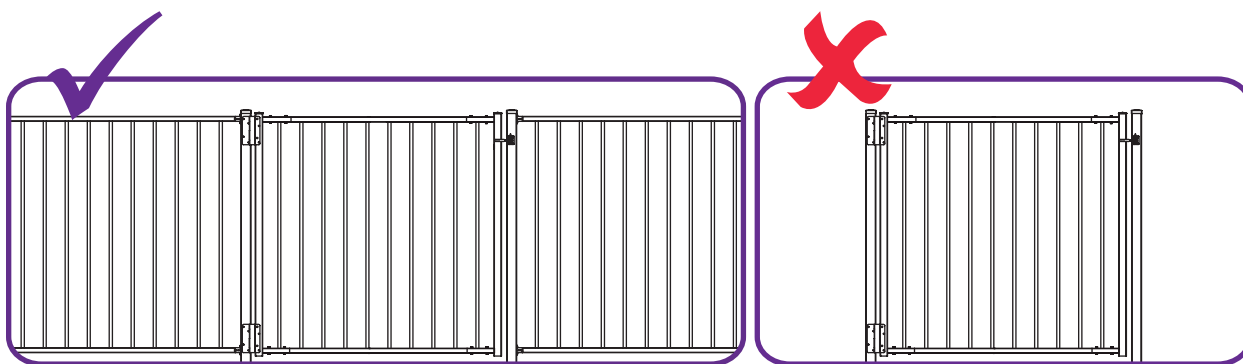

## DETAILED PRODUCT DIMENSIONS AND SPECIFICATIONS

This gate can be trimmed down both in width and height to accommodate custom applications.

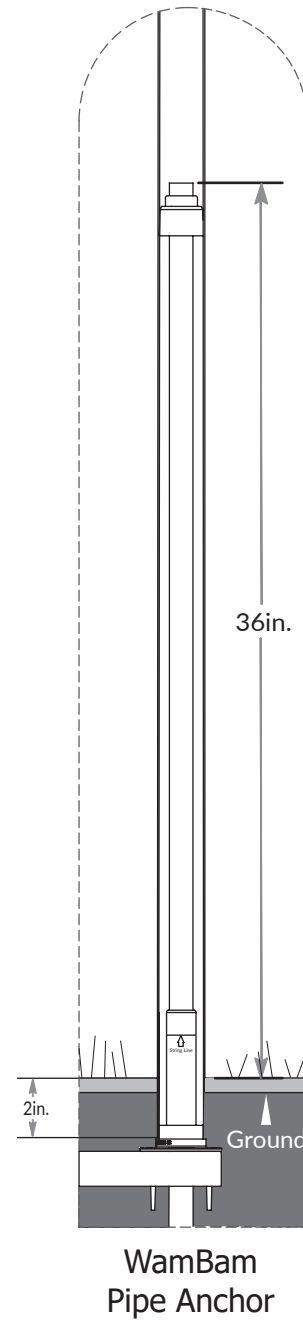
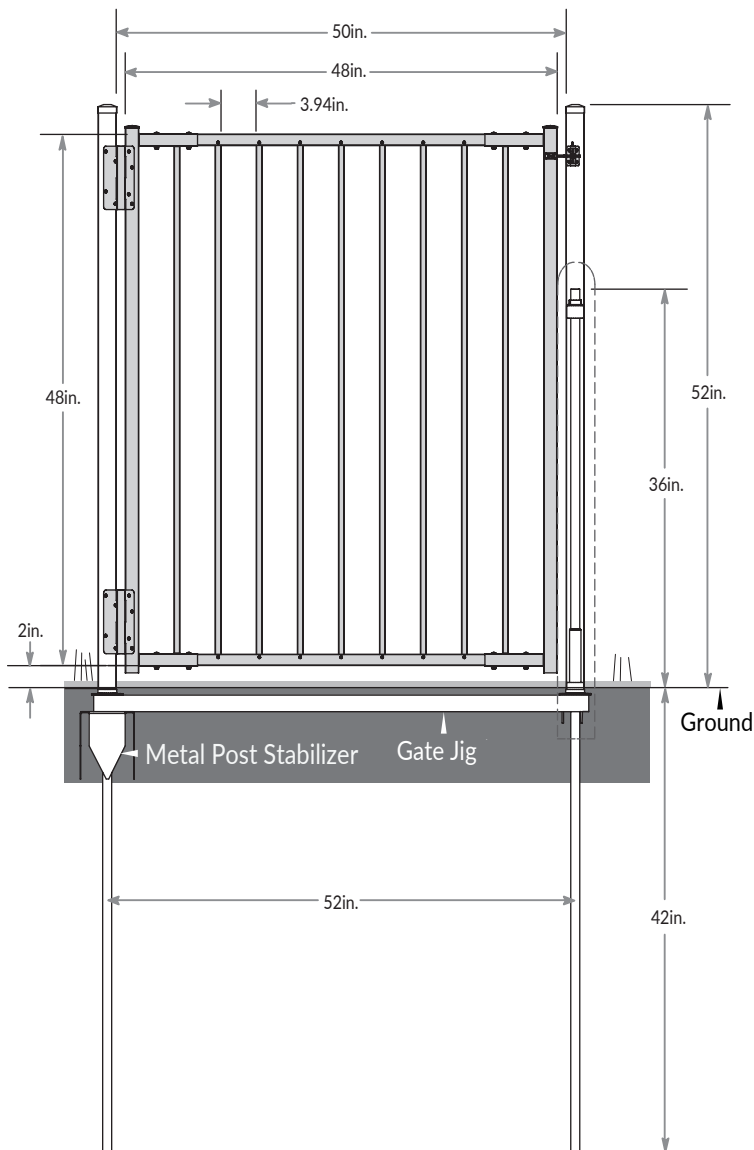

## STEP 1: LAY OUT MATERIALS

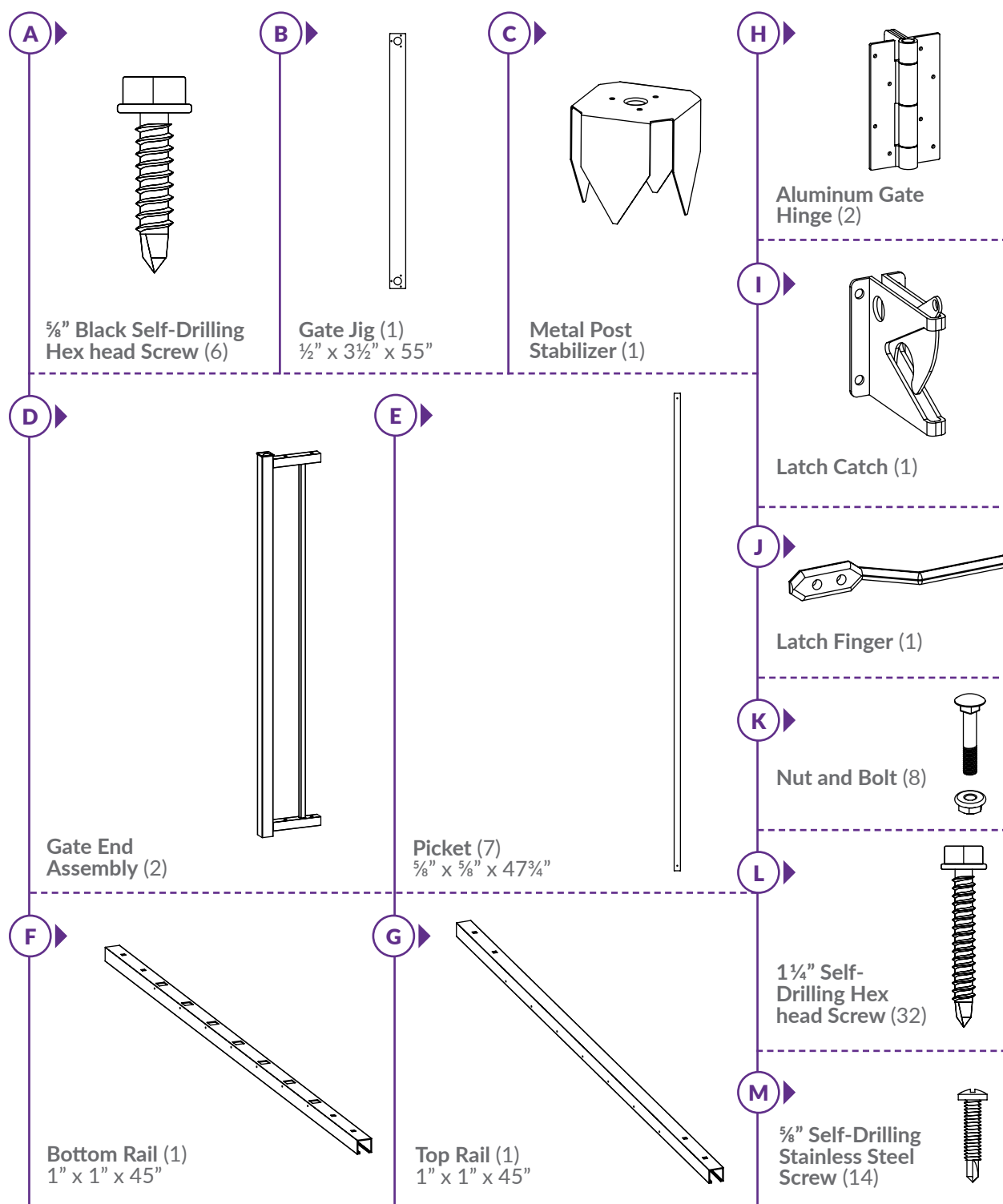

## STEP 2: INSTALL GATE JIG, POST ANCHORS, AND POSTS

### STEP 2.1 ▶

- ▶ Identify the location of your gate. Dig a trench 60" long x 6" wide x 2½" deep.

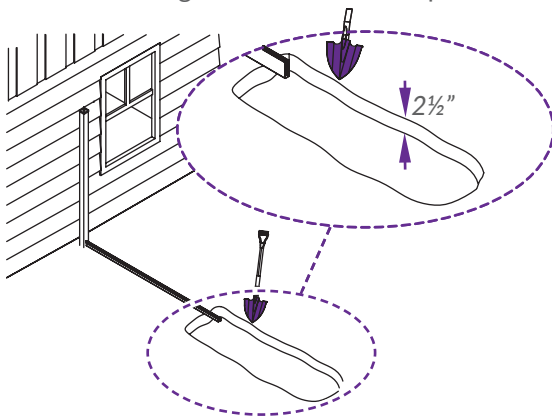

### STEP 2.2 ▶

- ▶ Identify the location of the Metal Post Stabilizer (C) and pound it into the ground. Temporarily place the anchor positioner into the metal post stabilizer and determine position.

**Note:** Metal post stabilizer to be used only on hinge post.

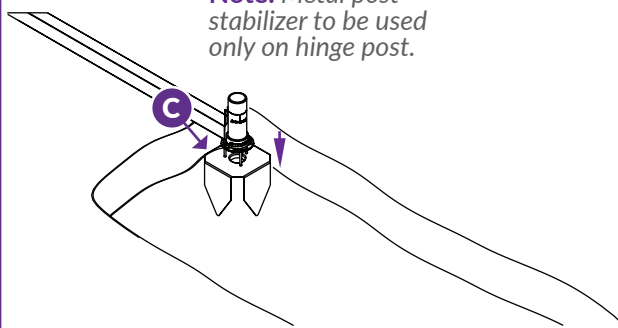

### STEP 2.3 ▶

- ▶ Place the Gate Jig (B) over the metal post stabilizer.

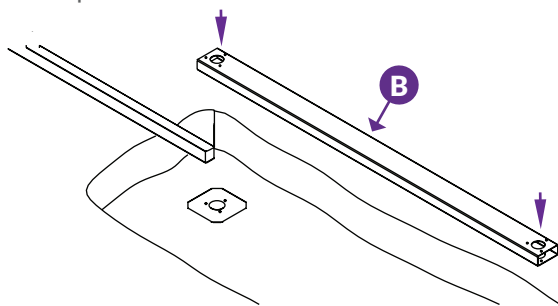

### STEP 2.4 ▶

- ▶ Place the anchor positioners into the gate jig. The pegs on the bottom of the anchor positioners will insert into both the gate jig and the metal post stabilizer.

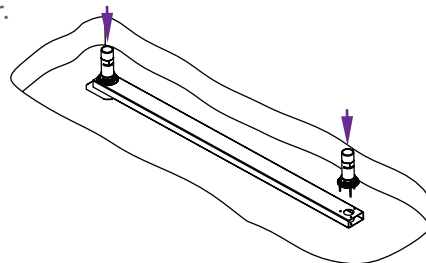

### STEP 2.5 ▶

- ▶ Pound your post anchors into place. See fence instructions, if necessary, for more information on how to install anchors. Adjust the leveling donuts and install the posts.

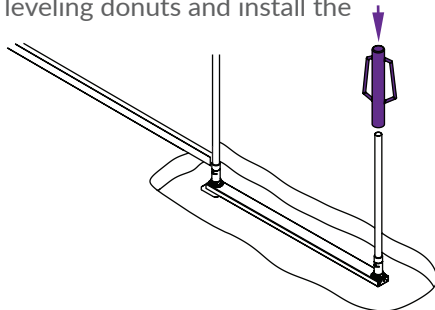

### STEP 2.6 ▶

- ▶ Backfill excavated dirt over the gate jig.

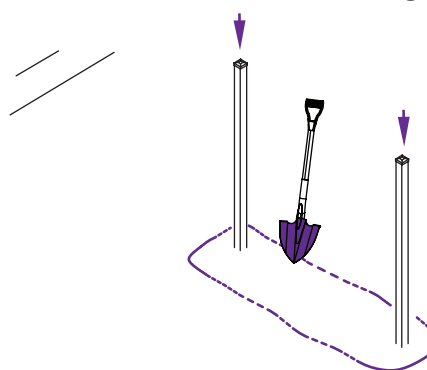

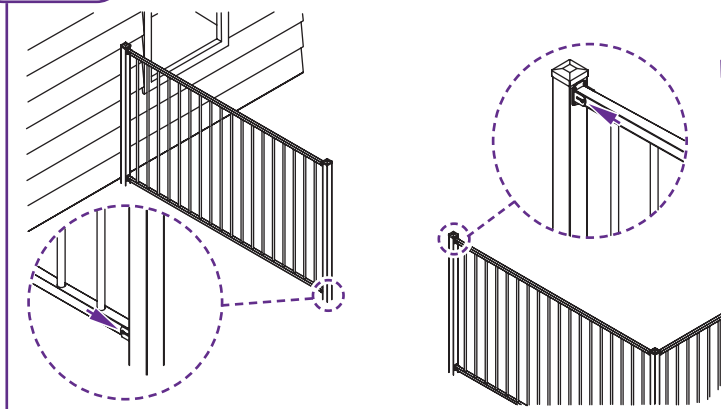
**STEP 2.7**

► Make sure to fasten the fence panels before attaching the gate.

**STEP 3: INSERT PICKETS****STEP 3.1**

► Insert the Pickets (**E**) into the Bottom Rail (**F**) and align the holes in the pickets with holes in the bottom rail.

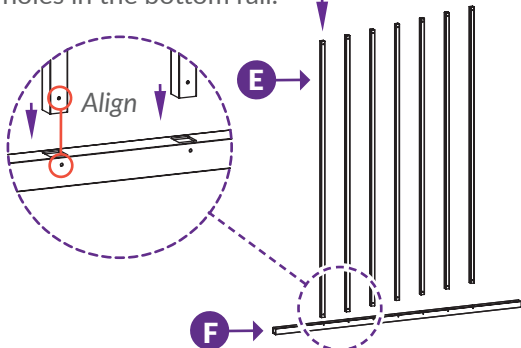
**STEP 3.2**

► Fasten (7)  $\frac{5}{8}$ " Black Self-Drilling Steel Screws (**M**). Adjust the torque setting to release at the point when the head of the screw is flush with the rail. If you force the screw, you will strip it.

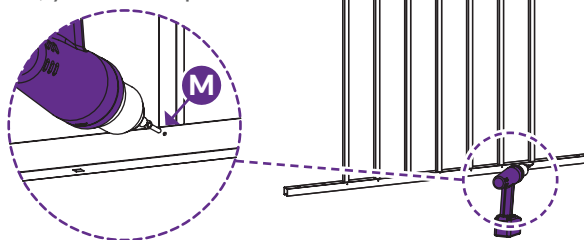
**STEP 3.3**

► Align the pre-drilled holes in the pickets with the pre-drilled holes in the Top Rail (**G**).

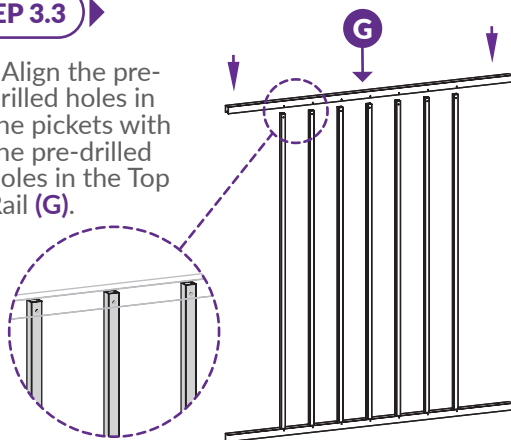
**STEP 3.4**

► Secure the pickets with (7)  $\frac{5}{8}$ " black self-drilling hex head screws

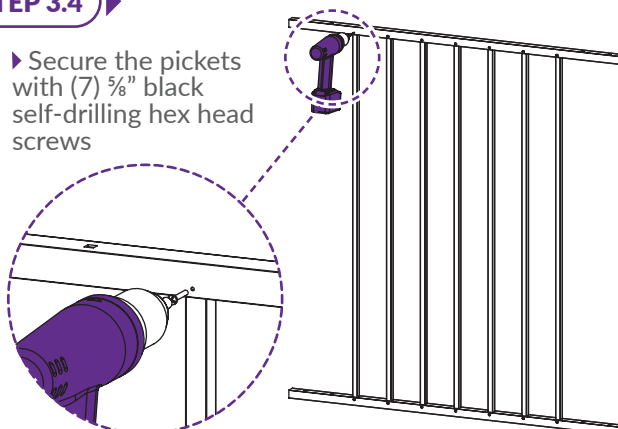

## STEP 4: FINISH ASSEMBLING THE GATE

### STEP 4.1 ▶

▶ Orient the Gate End Assembly (D) so it faces up to receive the assembled panel. Both rails must be inserted simultaneously to prevent binding.

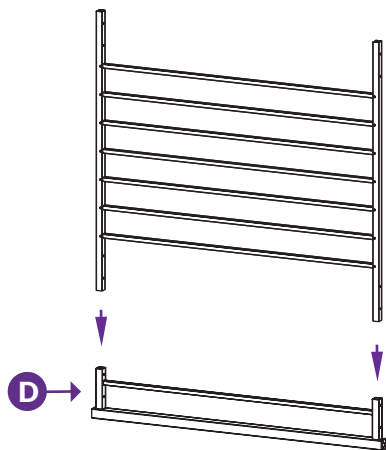

### STEP 4.2 ▶

▶ Insert the rails until the holes align for the bolt to be installed later.

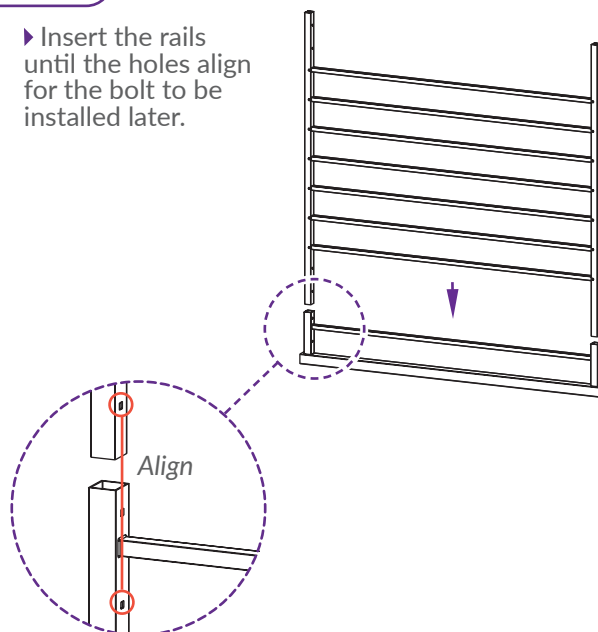

### STEP 4.3 ▶

▶ Flip the gate panel over, and insert it into the opposite gate end assembly.

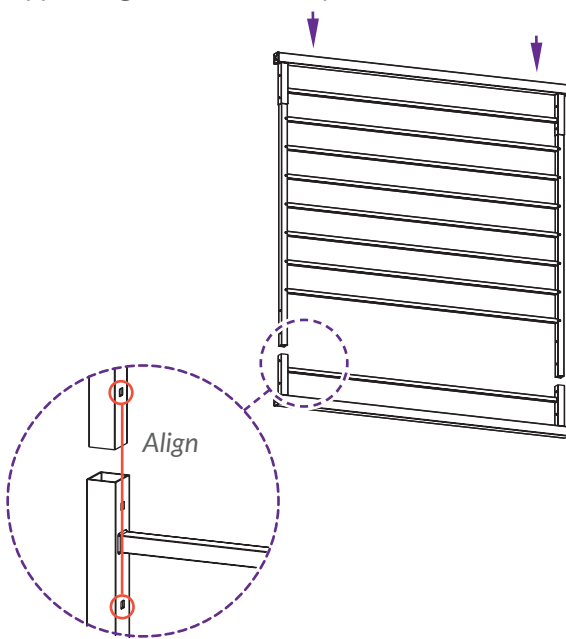

### STEP 4.4 ▶

▶ Insert the Bolts (K), fasten the nuts, and tighten.

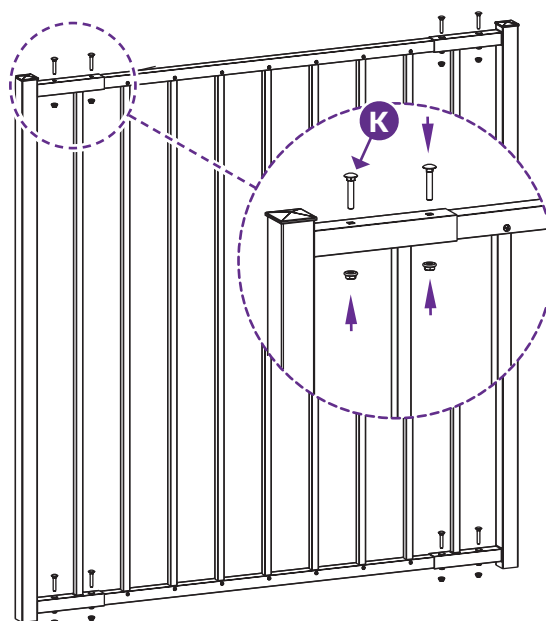



## STEP 5: ATTACH HINGES AND LATCH FINGER

### STEP 5.1 ▶

▶ Attach the Hinges (**H**) to the gate post with (8) total 1 1/4" Self-Drilling Hex Screw Screws (**L**).

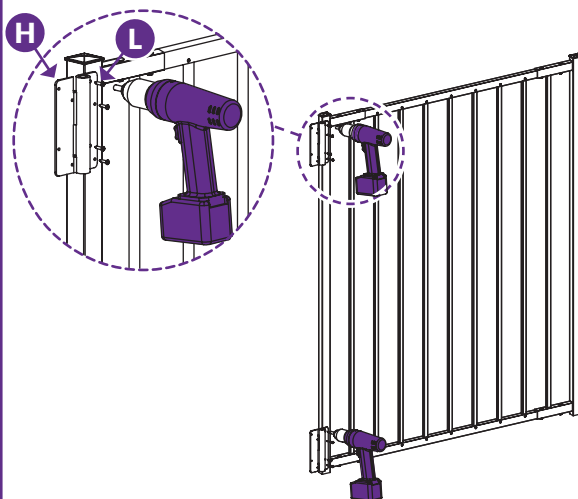

### STEP 5.2 ▶

▶ Attach the Latch Finger (**J**) to the gate post with (2) 5/8" Black Self-Drilling Hex Head Screws (**A**).

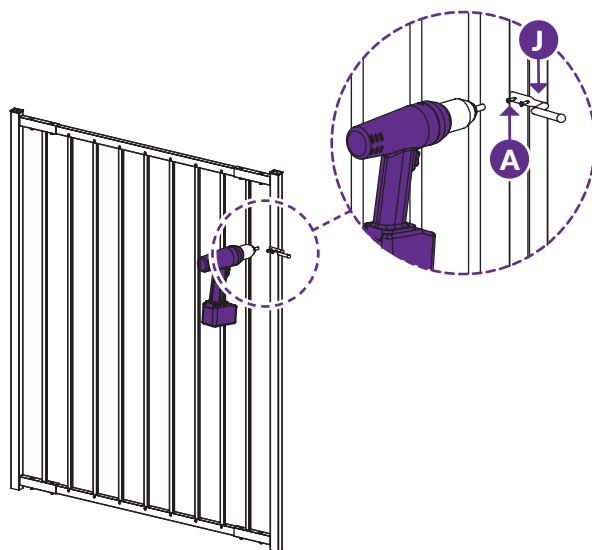

## STEP 6: ATTACH THE GATE TO THE FENCE PANEL

### STEP 6.1 ▶

▶ Use temporary spacers or blocks to rest the gate on during alignment and installation. Fasten the hinges using (8) total 1 1/4" self-drilling hex head screws.

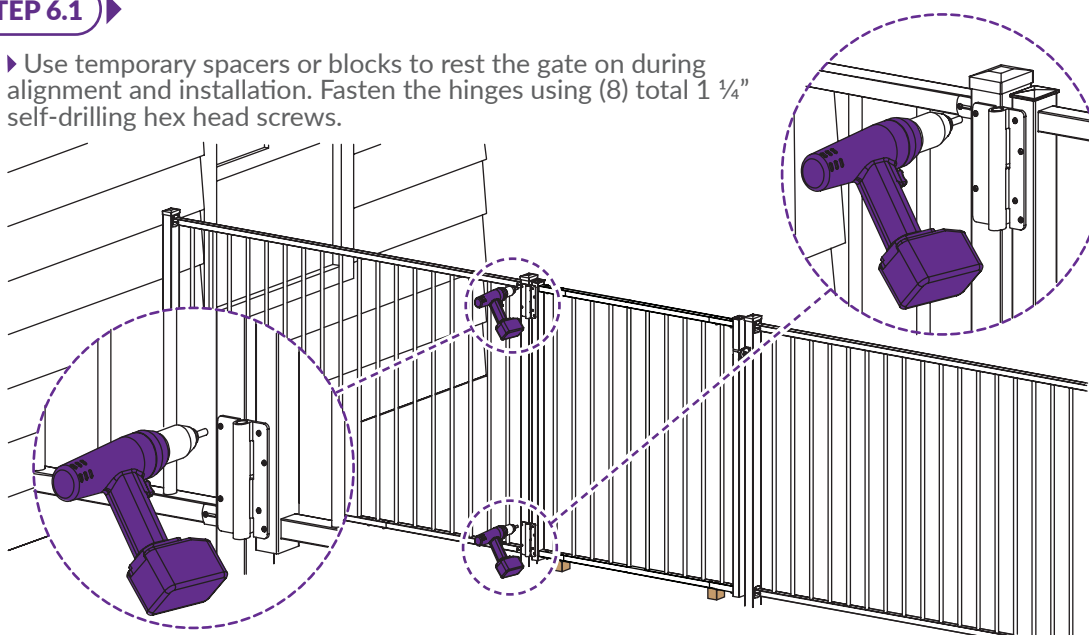

**STEP 6.2** ▶

1. Swing the gate open and drive (16) total 1¼" self-drilling hex head screws into the pre-drilled holes on the inside of the hinges.
2. Align and fasten the Latch Catch (I) to fit and function with the gate finger.

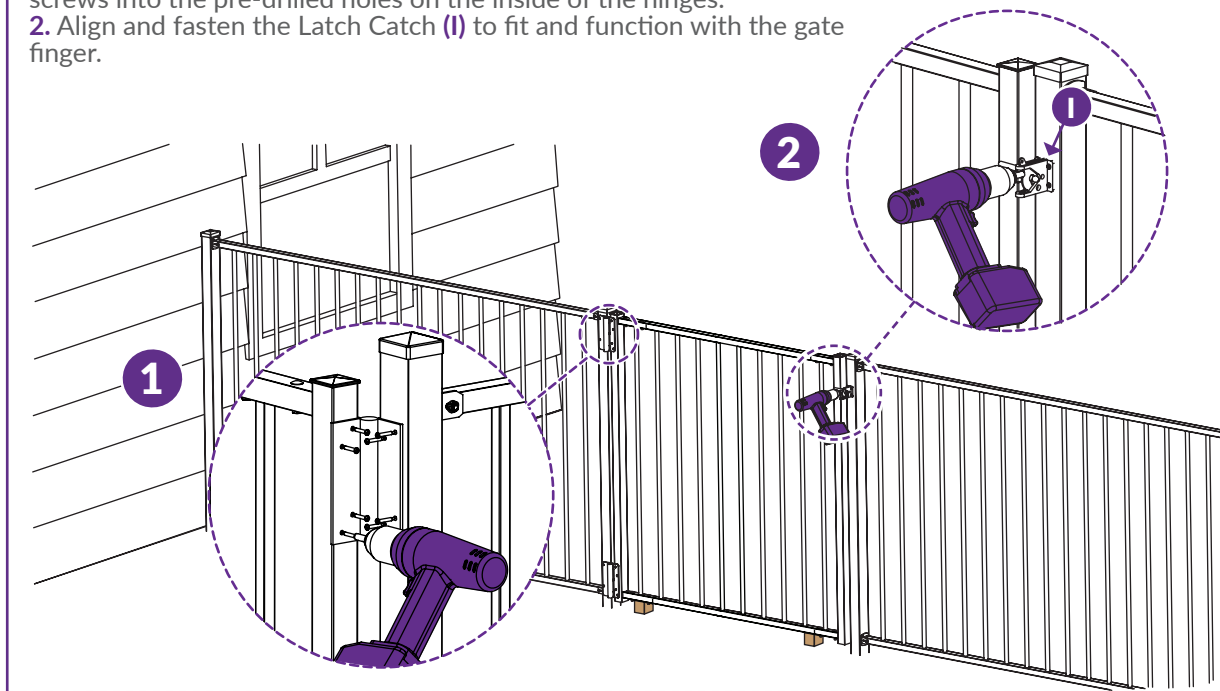

▶ Congratulations! You did it! Go grab a beverage of your choice, admire your handiwork, and show us what you got by entering our annual photo contest!

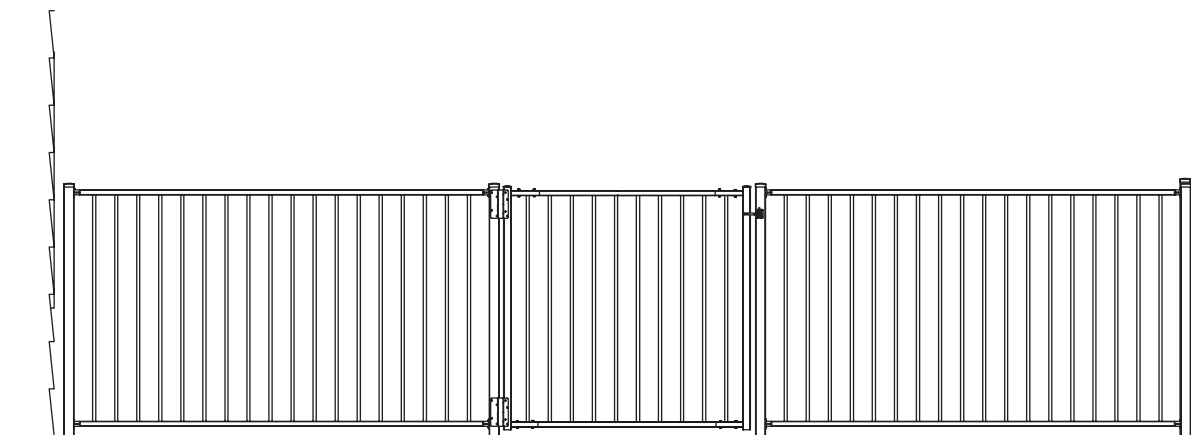

## ALTERNATIVE APPLICATION: INSTALL OVER A SIDEWALK OR PATH

### STEP 1.1 ▶

► **Option 1:** If the sidewalk is less than 52", use the gate jig as a temporary spacer. Proceed installing the panels according to the fence's install guide.

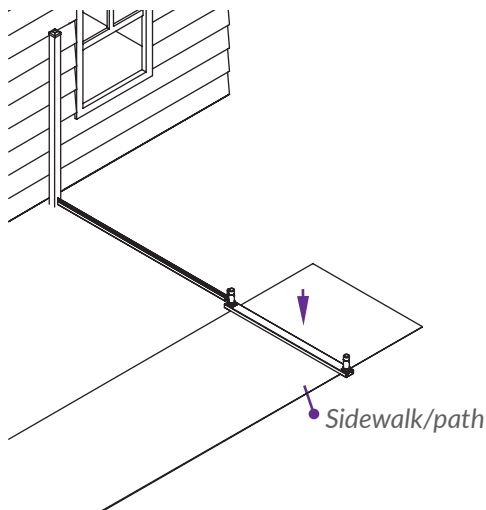

## ALTERNATIVE APPLICATION: INSTALL OVER A SIDEWALK OR PATH

### STEP 1.1 ▶

► **Option 2:** If the sidewalk is wider than 52", use surface mounts and follow the instructions included with them. Surface mounts must be purchased separately and can be found by searching item SKU AP60301.

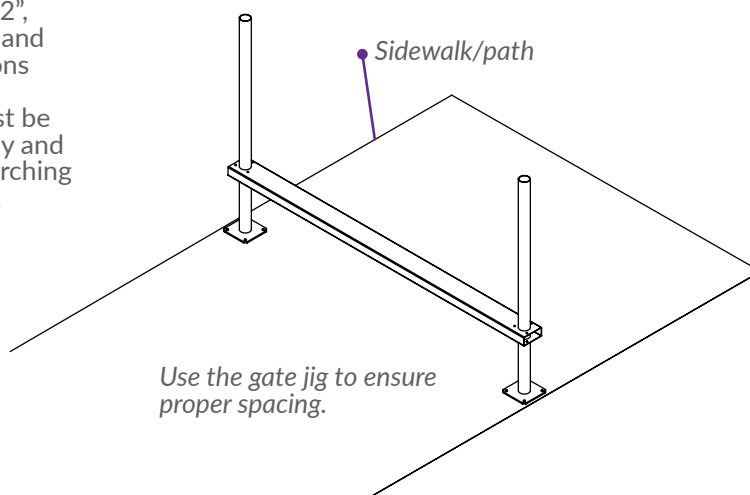

# WamBam

Fun Name. Serious Fence.



6935 Reames Rd. Ste. K.  
Charlotte, NC 28216



[hmmm@wambamfence.com](mailto:hmmm@wambamfence.com)

704-892-5222  
877-778-5733



[WWW.WAMBAMFENCE.COM](http://WWW.WAMBAMFENCE.COM)